

CL400 2V 400Ah(10hr)



The rechargeable batteries are lead-lead dioxide systems. The dilute sulfuric acid electrolyte is absorbed by separators and plates and thus immobilized. Should the battery be accidentally overcharged producing hydrogen and oxygen, special one-way valves allow the gases to escape thus avoiding excessive pressure build-up. Otherwise, the battery is completely sealed and is, therefore, maintenance-free, leak proof and usable in any position.

Battery Construction

| Component | Positive plate | Negative plate | Container | Cover | Safety valve | Terminal | Separator | Electrolyte |
|--------------|----------------|----------------|-----------|-------|--------------|----------|------------|---------------|
| Raw material | Lead dioxide | Lead | ABS | ABS | Rubber | Copper | Fiberglass | Sulfuric acid |

General Features

- Absorbent Glass Mat (AGM) technology for efficient gas recombination of up to 99% and freedom from electrolyte maintenance or water adding.
- Not restricted for air transport-complies with IATA/ICAO Special Provision A67.
- UL-recognized component.
- Can be mounted in any orientation.
- Computer designed lead, calcium tin alloy grid for high power density.
- Long service life, float or cyclic applications.
- Maintenance-free operation.
- Low self discharge.

Dimensions and Weight

Length(mm / inch) 210 / 8.27
 Width(mm / inch) 176 / 6.93
 Height(mm / inch) 330 / 12.99
 Total Height(mm / inch) 367 / 14.45
 Approx. Weight(Kg / lbs) 28 / 61.7

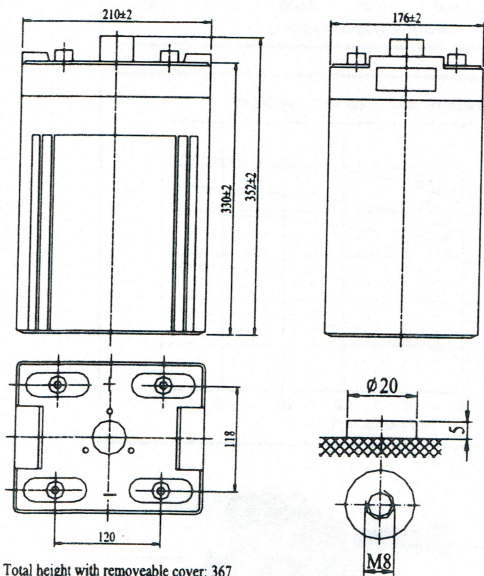

Total height with removable cover: 367

Performance Characteristics

Nominal Voltage 2V
 Number of cell 1
 Design Life 20 years
 Nominal Capacity 77°F(25°C)
 10 hour rate (40A, 1.8V) 400Ah
 5 hour rate (72A, 1.75V) 360Ah
 1 hour rate (247A, 1.6V) 247Ah
 Internal Resistance
 Fully Charged battery 77°F(25°C) 0.47mOhms
 Self-Discharge
 3% of capacity declined per month at 20°C(average)
 Operating Temperature Range
 Discharge -20~60°C
 Charge -10~60°C
 Storage -20~60°C
 Max. Discharge Current 77°F(25°C) 2000A(5s)
 Charge Methods: Constant Voltage Charge 77°F(25°C)
 Cycle use 2.35-2.45V
 Maximum charging current 80A
 Temperature compensation -5.0mV/°C
 Standby use 2.25-2.3V
 Temperature compensation -3.3mV/°C

Discharge Constant Current (Amperes at 77°F25°C)

| End Point Volts/Cell | 10min | 15min | 30min | 45min | 1h | 3h | 5h | 10h |
|----------------------|-------|-------|-------|-------|-----|-----|------|------|
| 1.60V | 732 | 587 | 427 | 325 | 247 | 114 | 77.7 | 43.0 |
| 1.65V | 694 | 559 | 408 | 312 | 238 | 110 | 75.9 | 42.4 |
| 1.70V | 654 | 530 | 388 | 298 | 229 | 106 | 74.0 | 41.7 |
| 1.75V | 614 | 500 | 368 | 284 | 219 | 102 | 72.0 | 40.9 |
| 1.80V | 573 | 470 | 347 | 269 | 208 | 98 | 69.4 | 40.0 |

Discharge Constant Power (Watts at 77°F25°C)

| End Point Volts/Cell | 10min | 15min | 30min | 45min | 1h | 2h | 3h | 5h |
|----------------------|-------|-------|-------|-------|-----|-----|-----|-----|
| 1.60V | 1281 | 909 | 740 | 641 | 493 | 310 | 214 | 140 |
| 1.65V | 1206 | 860 | 703 | 610 | 471 | 286 | 209 | 138 |
| 1.70V | 1131 | 810 | 665 | 576 | 449 | 270 | 203 | 135 |
| 1.75V | 1057 | 760 | 626 | 543 | 425 | 260 | 197 | 132 |
| 1.80V | 983 | 710 | 587 | 509 | 401 | 246 | 185 | 125 |

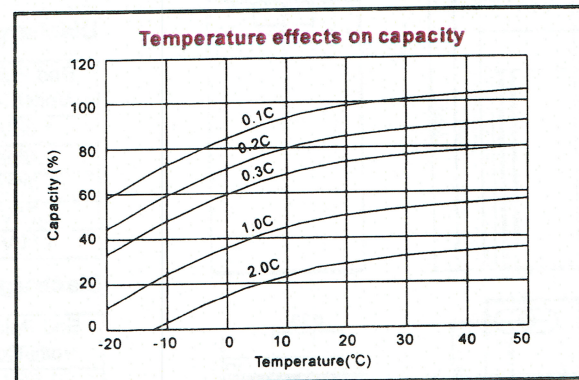
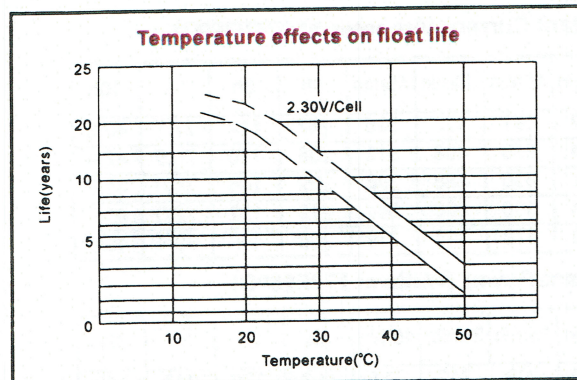
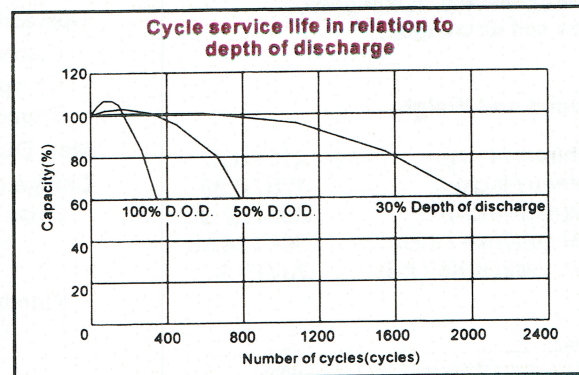
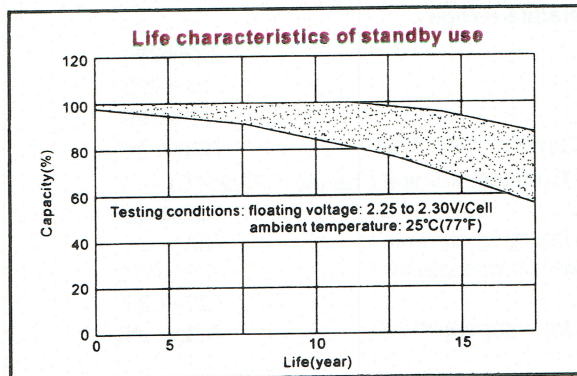
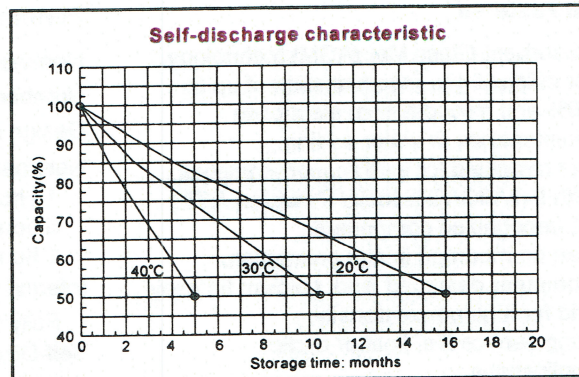
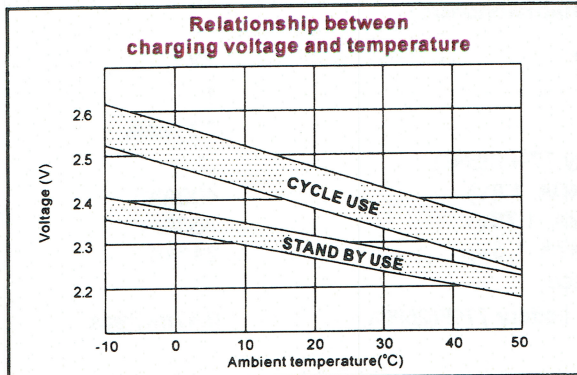
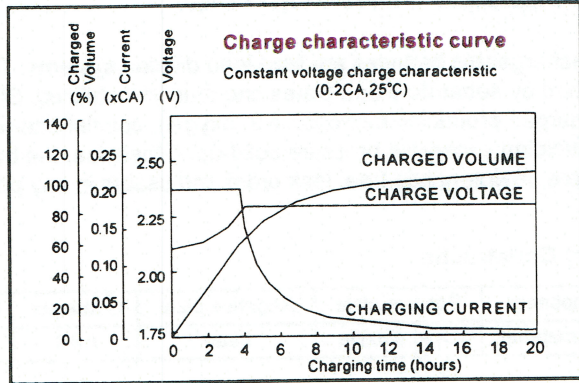
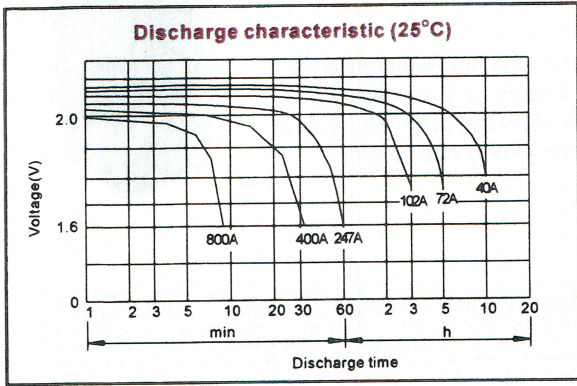

Center Power Industrial Park, Tongpu Industrial District Dapeng Town, 518120 Shenzhen, China

www.vision-battery.com